

Inside This Issue

Getting Started	1
Ridgeline Expansion	2
Welcome	2
Across the Sierras	3
Ponchos or Raincoats	4
Topographic Maps	4
Destination: Lookout	5
Board Notes	6
Trip Reports & Activities	7-14
Upcoming	15-18
At the Lodge	18
Classifieds	19
Calendar	19
Picture of the Month	20

Dates to Remember

June 16	ExploraTalk—Hart Mtn
June 24	Potluck—Grand Canyon
July 2	Bulletin Deadline
July 6	Board Meeting

Complete current schedules at:
www.observians.org or
 Register-Guard – Outdoors – Tuesday

Summer Schedule

There is no potluck in July and August and no Board meeting in August. The July/August Bulletin will go in the mail mid-July. There is not a separate August Bulletin. Any Bulletin submittals that pertain to August and early September activities need to arrive by July 2, the July Bulletin deadline.

Round & Round We Go

By John Jacobsen, President, Obsidian Board of Directors

THE ONGOING CIRCLE FOR THE OBSIDIANS starts as people are first introduced to our organization, some of whom may take part in some of our activities, and in turn, some of those may join our club. Hopefully some of those new members will become active members, involved in a wide variety of our activities, helping out on one or more of our committees, and after having gained some experience, heading one of our committees and/or leading hikes or other activities for us. Which brings us full circle, back to the beginning of introducing folks to the Obsidians through our activities.

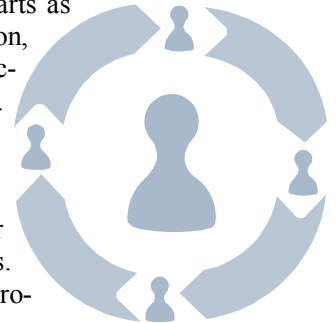

In an effort to focus on the beginning of this circle, and with hopes of stimulating the entire circle, a number of activities are planned in June to introduce people to the Obsidians and provide some clear avenues to learn about and get involved in the club. First, Janet Jacobsen is leading a series of Get Acquainted Hikes (see below) with no signup and no fees to provide a simple way for interested folks to connect with us. These hikes go from Hendricks Park, along the new Ribbon Trail, stopping at the Obsidian Lodge (always a pleasant surprise for people that have not been there before) for a visit and to answer guests' questions. Members from various facets of the Obsidians will go along on the hikes to help provide information about the varied offerings of the club.

Additional hikes are planned during the week following each Get Acquainted Hike so that interested guests have opportunities to achieve their membership requirements in short order. On June 24th the monthly potluck will feature a social hour at 5:30 pm (an hour before the regular 6:30 dinner) with a special invitation extended to participants of the Get Acquainted Hikes. Members are encouraged to invite friends or anyone who they feel might appreciate a chance to come to the Lodge or learn a bit more about the club.

So here's to a happy, healthy ongoing circle.

Get Acquainted Hikes

Three Get Acquainted Hikes are scheduled for both nonmembers and members, from Hendricks Park to the Obsidian Lodge along the Ribbon Trail:

Friday, June 17th at 5:30 pm, Saturday, June 18th at 10:00 am and 2:00 pm.

We will meet for the 2.5-mile hikes at the Hendricks Park parking lot on Fairmount by the Information Kiosk. The trip will take around 1½ hours. Prior signup is not necessary for nonmembers and no trip fees will be charged.

I would also encourage members to participate and have friendly, informative chats with guests, and invite them to the June potluck. I would prefer that members sign up online so additional members can be recruited if needed. Watch the schedule for monthly Get Acquainted Hikes for the rest of the summer and fall.

For information contact me at 343-8030 or bjacobsen@comcast.net

Janet Jacobsen, Get Acquainted Hikes Leader

Ridgeline Trail To Expand

by Joanne Ledet

THE RIDGELINE TRAIL SYSTEM IS expected to grow by 193 acres when the city acquires land from a Seattle resident sometime after Sept. 30. The land is northwest of Spencer Butte Park and is a combination of upland and wetland prairie and oak savanna and oak woodland. It is also home to sensitive species such as the Kincaid's lupine and Fender's blue butterfly.

The city has been negotiating for this property for almost ten years and recently was able to secure enough funding from various sources to make the purchase. Monies are being provided from Bonneville Power Administration, the Oregon Watershed Enhancement Board and the last of the money from the voter-approved 2006 parks bond measure. Financial concessions were also made by the property owner, Ed Miesen.

While this property is an important acquisition, it does not complete the proposed Ridgeline Trail system. The ultimate goal is to have a 20-mile recreation and habitat corridor extending from Mt. Pisgah to Fern Ridge Lake. This corridor would be a combination of hiking paths, forestland and open space.

Don't lace up your boots yet to hike this new property however, as funds for developing the land are not in the city budget. The 2006 parks bond measure was only to acquire land, not to develop it. So the city now has the challenge of finding monies to make this new property accessible to people who enjoy having a varied ecosystem almost in their backyard. While the time frame for usage of this property is uncertain, more importantly, it will soon be owned by the city and part of the parks system.

Editor's Notes: The Obsidian Board of Directors has supported the City of Eugene's efforts to expand the Ridgeline Trail system on several occa-

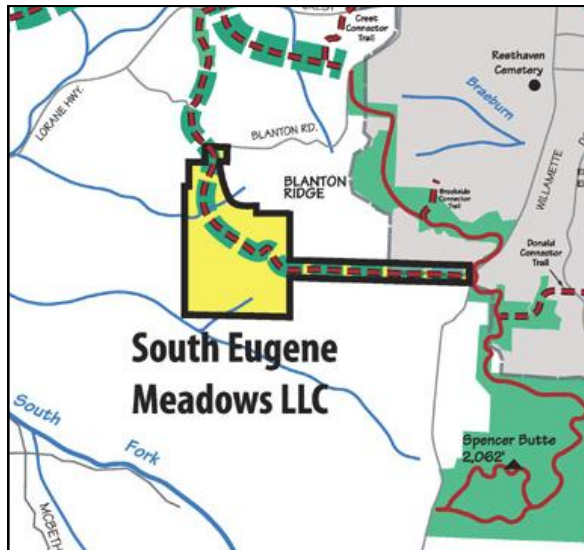

sions including a letter of support for Forest Legacy Program funds for this particular property in 2007. In addition to acquisition support the Obsidians' Trail Maintenance Committee has provided ongoing maintenance and upgrade to the Ridgeline Trail via monthly work parties.

This property, South Eugene Meadows in the map above, extends from Willamette Street on the east to Blanton Road to the northwest.

Welcome!

New Member

HARRIS, RICK (Active)
PO Box 1429, Springfield 97477
729-3460 rickanddanni@comcast.net

MACHAMER, BETH (Active)
1550 Walnut St, Eugene 97403
654-3805 beth.machamer@gmail.com

MARSHALL, LAURIE (Active)
35732 Zephyr Wy, Pleasant Hill 97455
726-8271 stephbristow@yahoo.com

Reinstated Members

MOFFITT, MICHAEL (Active)
90640 Nadeau Rd., Springfield 97478
968-1535 mmoff49@hotmail.com

OBSIDIANS, INC

P.O. Box 322, Eugene, OR 97440

Website: www.obsidians.org

Board of Directors

John Jacobsen, President
Lyn Gilman-Garrick, Vice President
Kathy Hoeg, Secretary
Stewart Hoeg, Treasurer
Matt Bell, Larry Huff, Verna Kocken,
Elle Weaver & Nancy Whitfield

Board meetings are held at 6 pm the first Wednesday of each month, except October when it is the Wednesday after the Annual Meeting, and no meeting in August.

Committee Chairpersons

Byways By Bus Liz Reanier
Climbs Larry Huff
Concessions.....Lyn Gilman-Garrick
Conservation/SciEd.....Joella Ewing
Entertainment Susan Wanser
Extended TripsJim Duncan
Finance Stewart Hoeg
Librarian/HistorianLenore McManigal
Lodge Building..... Doug Nelson
Lodge Grounds..... John Jacobsen
MembershipBarb Revere
OnlineWayne Deeter
Publications.....Joanne Ledet
Publicity..... Elle Weaver
Safety..... Sue Sullivan
Summer Camp..... Lana Lindstrom
Summer Trips..... Brian Hamilton
Trail Maintenance..... Matt Bell
Winter Trips..... Tom Musselwhite

The OBSIDIAN Bulletin

© 2011

Published monthly, except August and December. Articles, story ideas, letters to the editor and other editorial submissions should be emailed to:

bulletin@obsidians.org

For reprint rights, contact:

The Obsidian Bulletin

P.O. Box 51424, Eugene, OR 97405

Deadline

**for July 2011 Bulletin
Saturday, July 2, 2011**

Assembly/Mailing Team

For April Bulletin

Assembly & Mail Manager - Lou Maenz
Assembly Team - Clara Emlen, Yuan Hopkins, Joanne Ledet, John & Lenore McManigal and Margaret Prentice

Editorial Team

Writing & Editorial Staff - Bea Fontana, Ken Frazer, John Jacobsen, Joanne Ledet, Beth Roy and Ethel Weltman
Copy Editors - Beth Roy & Ethel Weltman
Graphics Design & Desktop Publishing - Stewart Hoeg & John Jacobsen

Across the Sierra Nevada... on Skis



*By John Pegg
Photos by John Manotti*

SUDDENLY THERE IT WAS! Half Dome and Yosemite Valley emerged out of the snow and swirling mist of clouds like a giant monster. We stopped on the narrow switchback, dumbstruck with the wonder of it all. After the struggle to pack up in a blizzard that morning and the hazards of skiing down Snow Creek drainage over rocks, logs and manzanita to the rim of the valley, the beauty of this place was proof we had done it, we had skied across the Sierra Nevada!

Five days earlier, we put on our skis at Mammoth Lakes ski area on the east side of the Sierra Nevada, shouldered our heavy packs, and skied off into the mountains. There were six of us, four of us Obsidians, with three tents, two stoves, and everything else we would need for this adventure. There would be nothing between us and Yosemite Valley on the west side except 51 miles of the wildest, most isolated and scenic wilderness in the world. Our one emergency item was a satellite phone, just in case.

The guide book called this route moderate. It winds its way past beautiful peaks and towers and over several easy passes until reaching the high point of the route on the second day, Donohue Pass at 11,100 feet. After this it is more or less downhill, ending in Yosemite Valley at around 4,000 feet. But every day was always a longer day than we wanted with sometimes difficult snow conditions and other obstacles to deal with. The route goes through Tuolumne Meadows where the Park Service maintains a ski hut available to back-country users and we enjoyed the wood stove and bunk beds as much as the magnificent rock domes and peaks that attract climbers from all over the world in summer.

We knew from the forecast that we would have three days of good weather, and that there was a chance of a little snow or rain for the next two days we would be out. We camped a day out of Tuolumne Meadows near Olmstead Point at the end of the fourth day, having had nothing but good weather.

But during the night it started snowing and we woke up in a blizzard, our tents almost buried in snow. This was not a spring snow shower; this was a winter storm. The ski down to the valley was tricky, but we found the critical bridge across Snow Creek and were able to follow the trail to the valley rim. There, we had to put our skis on our packs and walk down the miles of switchbacks in our ski boots to Curry Village where our car had been shuttled. Luckily, the world class views of Yosemite, mantled in new snow, were dramatic and beautiful beyond my dreams. I didn't even notice my exhaustion and blisters.



John Pegg descending from Donahue Pass

The other skiers on the trip were John and Lisa Manotti, Margaret Hoff, David Goodman, and my wife Deb Carver. John deserves all the credit for planning the trip, including talking me into going, arranging the car shuttle, and most of all for the often tricky navigation with topo, compass, and GPS that kept us on route.

Editors Note: This incredible trip was taken by John and friends May 11 through 15.

Poncho or Raincoat or Umbrella?

PONCHOS, RAINCOATS, AND EVEN AN UMBRELLA showed up on a rainy day hike on the Spring Basin extended trip (see trip report on Page 14). Wearing a bright red poncho, Jim Whitfield shared multiple reasons to choose a poncho over a raincoat:

- It is cheaper and weighs less than a good rain coat.
- You don't need a pack cover. It keeps my pack dry.
- Air flows underneath.
- If you don't wear rain pants, less of your legs gets wet than with a jacket.
- I can build a poncho shelter.
- It makes a little tent when you are sitting eating lunch or keeping warm .
- When opened and tied to trees, etc., it will shelter several people and gear.
- Opened up and laid on wet ground, it will keep two people and gear dry.
- If you're hurt or stranded, a brightly colored one is easily seen.
- If you add extra closures on the sides, wind isn't much problem. If wind is bad just hold sides with your hands. Hold inside and hands stay dry. Or use a belt.
- It doesn't matter if you gain or lose weight.



Jim Whitfield (poncho proponent) Sharon Friedland (favors umbrella and raincoat). At least when the discussion turns to color there will be no disagreement. Photo by Nancy Whitfield

Topographic Maps... Are You Ready?

SO... YOU'RE READY TO LEAD YOUR HIKE. You've done the necessary preparations, contacted your hikers, packed your Ten Essentials (or so you think), arranged for transportation, etc. Your Bill Sullivan book is handy, complete with its road directions and trail map. You're set, right?

Not so fast. Did you notice Bill's caveat beginning "All hikers should carry a topographic map, with contour lines..."? Oops. What if your trail is overgrown, or a footbridge is down, or trees have fallen and clogged a section of your path? Do you have a viable alternative?

It is very important to have a topographic map in a waterproof map case. This keeps all the information clear in case you need to refer to it. These maps allow you and your group the confidence to hike without trepidation, providing you with details about elevation, distance, spur trails, alternate routes, and so forth.

There are numerous ways to acquire the map of your choice. You can go online to purchase one at

www.naturenw.org (Northwest Information Center) or get a free download at www.topozone.com (U.S. Geological Survey). If you'd rather order by phone, try Imus Geographics at 541-344-1431. For those who prefer dealing with a real person face to face, go to a Forest Service office or ranger station. You might also try the Map Room at the Knight Library, where I understand you can make a copy of your map for a nominal fee. Yet another option is a store like REI. In other words, topographic maps are plentiful and easy to acquire, in addition to being a valuable resource.

I hope this article entices our hike leaders to grab a topo map well in advance of the hike. I also sincerely hope more of you who are reading this might decide to lead a summer hike. There are still many excellent outdoor adventures awaiting a willing leader. Check the schedule online or published in last month's Bulletin to check for open dates and a good spot to lead your favorite hike. Then contact:

summertrips@obsidians.org

Don Colgan, Summer Trips Committee

Destination: Lookout

By Janet Jacobsen

Editor's Note: In last month's Bulletin, Janet wrote about the many Oregon lookouts that you can hike to. Here she presents some of those hikes on the Obsidian schedule this summer.

HIKE TO A FIRE LOOKOUT SUMMIT and along the way, enjoy the wildflowers.

Tire Mountain - Moderate

Sat. June 18, Jim Pierce—Wildflowers should be at their peak for a hike through numerous meadows along a ridgetop trail to a former lookout. In the 1920s there was a crow's nest, a platform on a topped tree. The old foundation of a 1932 three sided shelter remains. *See the photo of Tire Mountain below provided by Curtis Irish from his extensive collection.*

Iron Mountain - Moderate

Sun. June 12, Sue Wolling; Sat. June 18, Dan Christiansen; Sun. June 26, Becky Lipton—The lookout on this spectacular wildflower hike was destroyed in 2007 and replaced with a viewing platform.

Olallie Mountain - Moderate

Sat. June 25, Peter Graham—Located in the Three Sisters Wilderness, this L-4 cab, built in 1932, was last used for

emergencies in the 1970s. The building is listed on the National Historic Lookout Register.

The Three Pyramids - Moderate

Sat. June 25, Mary Hamilton—The Three Pyramids lookout was built in 1934 and destroyed in 1968. Surrounded by cliffs, the lookout tower site offers great views.

Bunchgrass Ridge - Difficult

Fri. June 24, Chris Stockdale—The trailhead begins near the Little Bunchgrass lookout site, 1933-1968. Chris said that she has never looked for the former lookout but perhaps it is further down the road from where they park. Sign up and help investigate.

Rebel Rock - Difficult

Sun. June 26, Larry Huff—Located in the Three Sisters Wilderness, the L-4 cab built in 1955 and abandoned since the 1960s is in a saddle one mile southwest of the summit. One can look for phone lines and insulators intersecting the trail. If the 14-mile hike sounds a bit daunting, go to this website for a 2002 photo tour:

<http://www.forestlookout.com/rebelrock>



BOARD NOTES

May 1, 2011

By Jim Duncan

President John Jacobsen called the meeting to order at 6:03pm. Board members present: Matt Bell, Larry Huff, Verna Kocken, Elle Weaver, and Nancy Whitfield. Also present: Wayne Deeter, Jim Duncan, Brian Hamilton, Janet Jacobsen, Joanne Ledet, Doug Nelson, Jim Pierce, Sue Sullivan, and Susan Wanser.

Prior to the start of official business, Janet presented Matt Bell with books for Baby Bell as well as a gift of 3 months of diaper service for the new addition to the Bell family.

Treasurer's Report: The Board approved payment of bills.

COMMITTEE REPORTS

Elle raised a question about putting more recent press items about the Obsidians on the Obsidians home page, pointing out that there have been several recent articles about the club in the Register-Guard. The consensus was that this should be done.

Summer Trips (Brian Hamilton): Since the May 4 Board meeting, sixteen trips were completed, with 94 members and 16 nonmembers. \$156 in trip fees was collected. The trips included two bike trips, one water outing, and thirteen hikes.

Two additional trips have been completed and online trip reports were submitted, but the committee has not received trip fees and signup sheets yet.

Winter Trips (Tom Musselwhite): Three snow trips were completed in May, for a total of 57 trips approved and completed for the 2010-2011 Winter Trips Season.

Trail Maintenance (Matthew Bell): One trail maintenance outing was held on the main Spencer Butte Trail on May 23rd. We broke into 2 groups. One group continued to remove the peeler cores from the turnpike section near the trail junction meadow. The second group continued up the trail to brush some switchbacks and repair a section of barrier fencing.

Byways By Bus (Liz Reanier): On May 17th and 18th, the bus group of twenty riders, including 5 nonmembers traveled to the Oregon Gardens, Moonstone Resort, and Silver Creek Falls. The next

trip is to the Oregon Zoo and will be lead by Liz Reanier and Rick Ahrens.

Extended Trips (Jim Duncan): An additional extended trip has been added to the schedule: kayaking on the Rogue River, August 12-14, led by Valerie Metcalfe.

Conservation, Science, & Education (Joella Ewing): Thirty-four people attended the May ExploraTalk and \$32 was collected. Lyn has arranged the June 16 (Thursday) ExploraTalk with a presentation by a representative of the Hart and Sheldon Wildlife Refuges.

Publication (Joanne Ledet): No bulletin in August so any activity occurring in August through mid-Sept. should appear in the July Bulletin.

Entertainment (Susan Wanser): There were 38 people present for dinner and 45 present for the presentation from the Biker Boys of Springfield High on May 27. \$33.93 was collected. The next potluck will be on June 24th and will include a presentation on hiking in the Grand Canyon. There will be a social hour beginning at 5:30 prior to the dinner.

Membership (Barb Revere): The Board approved three applications for membership: Rick Harris, Beth Machomer, and Laurie Marshall. Mike Moffitt was reinstated as a member.

Publicity (Elle Weaver): A new supply of Obsidians brochures was ordered.

Concessions (Lyn Gilman-Garrick): The Concessions Committee took in \$36 at the ExploraTalk on May 17th and \$10 at the potluck on May 27th. We held a drawing at the potluck for a vest. Ray Jensen was the lucky winner.

We have ordered a new item from McKenzie by SewOn- bandannas in four colors - red, green, royal and purple.

Online (Wayne Deeter): From John Jacobsen: We are getting a lot of registrations for online signups, but many are not resulting in trip signups and new memberships.

From Jan Jacobsen: She has gotten a lot of positive comments from those in outlying areas (Creswell, Cottage Grove, Veneta, Crow, Junction City, Springfield), many saying they wouldn't be signing up without it. She says it's also

very convenient from a leader's perspective-- being able to keep track of signups without going down to the Y, having signees able to cancel online instead of calling, and being able to read their names and phone numbers instead of having to try to decipher their hand-written scrawl.

Library/Historian (Lenore McManigal): All of the trips printed in the May Bulletin, have been recorded in the member's activity sheets.

Lodge Building (Doug Nelson): Thanks to Janet Jacobsen and Jane Hackett for volunteering to mop and wax the floors early in the month. There have been several inquiries but no new rental arrangements to report. Expenses will be reported at our next meeting.

Lodge Grounds (John Jacobsen): Work party May 5: Cleaned up for Lodge rentals that weekend. Mowed, cleaned out blackberries, cleared drives and parking areas. Work parties May 26 & 27: Pre-potluck cleanups. Mowed, cleared drives and parking areas, bucked up downed firs, cleared out some branches.

OLD BUSINESS

John announced that the annual meeting of the FWOC would be held Aug. 26-28 at the Mazama Lodge. Previously Dave Predeek and Don Colgan had expressed interest and John will follow up with them about possibly attending the meeting.

NEW BUSINESS

Janet Jacobsen discussed the possibility of obtaining a bookcase for the small alcove near the stairway on the main floor. The Club owns several books, some authored by members, and having them in that location would make them more accessible to the members. Wes Prouty would be consulted about building the bookcases. Another suggestion was that something more attractive be considered to replace the shelves under the nametag board. An ad hoc committee consisting of Janet Jacobsen, Sue Sullivan, Doug Nelson, and possibly Sharon Duncan will look into making these changes. One further suggestion was that the committee examine the possibility of having the old Obsidians painting (found several years ago) restored, perhaps as a tribute to the bequest of Catherine Jones.

TRIP REPORTS & OTHER ACTIVITIES



Hikes

McKenzie River Trail by Bus

April 20, 2011

Leader: Jim Pierce

Hike: 8 miles, 300 ft. (Moderate)

WE HAD A GREAT DAY ALONG THE CLEAR, BOUNCING MCKENZIE RIVER with its constant, gentle gush. We spotted white-crowned sparrows and winter wrens called incessantly. The forest is so diverse: huge incense cedars and Douglas firs along with western red cedar, hemlock, Pacific yew and alder. The understory is a complex mix of Oregon grape (almost in bloom), sword ferns, salal, vine maples and rhododendrons, all covered with thick mosses. There were HUNDREDS of trillium, calypso lilies, yellow violets, and wild geraniums. There was a seven-foot section of trail where we counted 29 calypso lilies. The trail had a few muddy spots, but not bad. Most of the downed branches have been cleared. The warm pool at Belknap Hot Springs was a special treat. Members: Jim Pierce, Nancy Whitfield.

Spencer Butte/Amazon Headwaters

April 24, 2011

Leader: Janet Jacobsen

Hike: 6.4 miles, 1530 ft. (Moderate)

THE PREDICTION FOR RAIN PROMPTED SEVERAL ONLINE CANCELLATIONS, leaving three nonmembers to hike up Spencer Butte for the first time. Recently moved to Eugene, Doug participated on the trail maintenance project the day before. Laura and Jesus, OSU students, began their Eugene adventure the night before with contra and tango dancing. Their Google search for Martin Street led them to Owl Street off of Fox Hollow but somehow in the nick of time we were able to meet up at the Fox Hollow trailhead. It almost turned into a misadventure when Jesus accidentally locked his keys in the car. His dexterity with a clothes hanger saved the day. As for the weather, there was a light rain for a few minutes when we ate our lunch on top. Flower update: fawn lilies, calypso orchids, trillium, fairy bells, and bleeding hearts were welcome spring color along the trail. Near the summit we discovered shooting stars and grass widow. It was fun to share the trail with such appreciative folks even if two of them wore orange and black clothing. Members: Janet Jacobsen. Nonmembers: Jesus Alc, Laura Soto, Douglas Becker.



Hiking across the new bridge over the N. Fork Smith River, a big improvement over the bare logs that were there.

Trestle Creek Falls Shuttle

April 30, 2011

Leader: Lynda Christiansen

Hike: 7.5 miles, 1000 ft. (Moderate)

HEAVY PRECIPITATION THIS WINTER guaranteed that Trestle Creek Falls would be roaring, and we were not disappointed. The day began with gray skies and we were not surprised to find snow at the 3,000-foot elevation of the falls. One car was left at the lower trailhead, and our small group began our hike with the loop up to and under the falls, then followed Brice Creek down the trail which is in good shape despite the wet winter. Flowers along the way included trillium and calypso orchids, as well as spring beauty. Rain showers held off, and we had some sun toward the end of the day. Members: Lynda Christiansen, Laurie Funkhouser, Art Kearney, Nola Nelson. Non-members: Barry Taub.



Soggy hikers on Hardesty after ascending Eula Ridge.

N. Fork Smith River & Sweet Creek

May 1, 2011

Leader: Rob Castleberry

Photo: Ernst Schwintzer (Page 7)

Hike: 10.5 miles, -1400 ft. (Moderate)

The rains paused and the clouds parted for a sunny May Day in the Coast Range. Ed Lizewski had generously offered to drive a shuttle car to the lower end of the trail and walk upstream to meet the rest of us, saving most of an hour for shuttle setup. Kentucky and North Smith falls were thunderous with abundant spring runoff. Fresh spring green was the color of the day. Vine maple leaves were just emerging, and flowers were delayed by cool weather. We rock-hopped across side streams, sharing trekking poles for balance. Since the last Obsidian hike along this trail, the Forest Service rebuilt several bridges, so no need to slide along logs for a precarious river crossing. From the lower trailhead we drove to the north, crossing into the Sweet Creek drainage. Four of our group continued back to town while the rest of us took another dose of ozone and streamside energy, walking the Sweet Creek trail before return home. Members: Rob Castleberry, Paul Flashenberg, Betty Grant, Janet Jacobsen, Lana Lindstrom, Ed Lizewski, Diane Pergamit, Ernst Schwintzer. Nonmembers: Diane Kurz, Rick Harris.

Larison Rock

May 4, 2011

Leader: Janet Jacobsen

Hike: 8 miles, 2400 ft. (Difficult)

NO SNOW. NO MOUNTAIN BIKES. NO COUGAR SIGHTINGS. No large trees blocking the trail (just a few bushy branches). It took us two hours to reach the rock where, like lizards, we basked in the sun for an hour and considered ourselves most fortunate. One lone anchor bolt was a clue for what seemed like an impossibly small space for a fire lookout. Yes, the first lookout was built in 1918: see <http://www.firelookout.com/or/larisonrock.html>.

Members: Melody Clarkson, Janet Jacobsen, Chris Stockdale, Elle Weaver, Kathleen Willett.

Eula Ridge

May 7, 2011

Leader & Photo: Jim Pierce

Hike: 8 miles, 3500 ft. (Difficult)

EIGHT STALWARTS BRAVED SOGGY WEATHER to hike up Hardesty Mountain via the Eula Ridge trail. The leader delivered the promised steep, muddy trail with snow for the last half mile. The forest greens were accented by trilliums, calypso orchids, yellow violets, wild geraniums and, down low, bleeding hearts and oxalis. Grouse serenaded us part of the way. The ascent took just over three hours. At the top, we ate lunch in the rain. The descent took 2.5 hours. It was a wonderful outing with great company, and a good workout. Members: Marianne Camp, Danneille Harris, Daphne James, Jim Pierce, Brian Popowsky, Chris Stockdale, Elle Weaver. Nonmembers: Rick Harris.

Waldport to Yachats

May 8, 2011

Leader: Janet Jacobsen Photo: Keiko Bryan (Page 9)

Hike: 7 miles, 0 ft. (Moderate)

THERE WAS A 70% CHANCE OF RAIN PREDICTED. Who would have thought that instead of rain pants we needed sunglasses and sunscreen for our beach walk? The calm waves spread peacefully on the open expanse of beach as we wondered how fortunate we were to celebrate Mother's Day on such a gorgeous day. We left Eugene at 7:30 am, started hiking on the trail near Adobe Motel at 9:45, ate lunch at Tillicum Beach Park at 11:00 and arrived at Patterson State Park around 1:00. It was a minus low tide at 10:40 am, allowing us to easily wade across the streams and get our boots wet. Marianne and Keiko shed their waterproof boots and went barefoot. Thanks to Sam and Jane for driving us out of the rain in Eugene and taking charge of the shuttle. Another thanks to Brigitte Williams who has led this hike 11 times and gave me lots of tips about tide tables and the best times to lead it. Members: Keiko Bryan, Marianne Camp, Jane Hackett, Janet Jacobsen, Sandra Larsen, Patricia MacAfee, Sam Miller. Nonmembers: Keith Christensen, Laurie Marshall.

Mt. Baldy

May 10, 2011

Leader: Ruth Romoser

Hike: 5 miles, 500 ft. (Moderate)

WE HAD A WONDERFUL HIKE UP MT. BALDY. We saw lots of wildflowers and it was a beautiful sunny day! Jan showed us a shortcut to the trailhead which saved some uphill trekking. We walked down to our cars via Agate Street and the entire hike took about three hours. Members: Rick Ahrens, Dick Hildreth, Janet Jacobsen, Sandra Larsen, Ruth Romoser.

Upper McKenzie River Trail

May 14, 2011

Leader: David Morris Ass't Leader: Joe Sanders

Hike: 7.5 miles, 750 ft. (Moderate)

FIVE OF US LEFT THE SEHS PARKING LOT right at 8 am and picked up the sixth hiker in Walterville. It was overcast with a threat of rain in the air, but luck was on our side and we had no rain for the entire hike. We parked our shuttle at Carmen Reservoir due to snow above Koosah Falls. It was a chilly start on the trail but we quickly warmed up as soon as we started hiking. Soon the trail joined up with McKenzie River and we stopped several times to look down on the river from high on the trail. In no time at all we were enjoying the beauty of Blue Pool. The

trail continues along the dry river bed for a couple of miles. Our attention turned to the snow on the trail, the old growth forest, the cliffs on the far side of the dry river bed, and the trillium that was in bloom. Just above Carmen Reservoir the patches of snow got a little deeper, but soon we were at Koosah Falls. There was a lot of water flowing over the falls and we were all impressed. We took a vote and decided to continue on to Sahalie Falls. Just around the next bend the snow got deeper. After a quick scout of the trail we decided to return to our shuttle. Near the end of the hike the sun broke through. Members: Liz Jones, David Morris, Brian Popowsky, Joe Sanders, Nancy Whitfield. Nonmembers: Linda Rubenstein.

Sweet Creek Falls

May 14, 2011

Leader: Joanne Ledet

Hike: 2.5 miles, 250 ft. (Easy)

THE THREAT OF RAIN MAY HAVE DISCOURAGED SOME PEOPLE from hiking Sweet Creek Falls on May 14, but the three hikers who participated enjoyed a creek full of water and an abundance of wildflowers. We left at 9:00 and picked up a little mist as we drove west, and the light mist stayed with us for most of our hike. The wildflowers were thriving with the moisture and we saw large areas of bleeding hearts, false Solomon's seal and scattered beds of wartberry fairybell. There were even a few last-



Hiking Waldport to Yachats along the beach at low tide. May 8.

of-the-season trillium. Amy found a wildflower that I could not find in my wildflower book so we decided to name it after her. Since we so thoroughly enjoyed the many vistas of cascading waterfalls that Sweet Creek affords, we decided to take an additional hike to Beaver Creek Falls. The waterfall created by Beaver Creek flowing into Sweet Creek is well worth the additional short hike. Members: Joella Ewing, Joanne Ledet. Nonmembers: Amy Miller.

Castle Rock

May 15, 2011

Leader: Chris Stockdale Photo: David Adkins

Hike: 11.4 miles, 2600 ft. (Difficult)

IN ANTICIPATION OF A WET DAY (thanks to the varied weather forecasts we get in Eugene), our packs were stuffed with rain-gear as well as warm clothing. Predictions of the snow level at 4,000 feet concerned us as well since we would be climbing to just under that. But our luck held and the day stayed dry. A fast pace up this well-graded trail through the forests got us to the summit in 2 hours and 15 minutes. We found very limited views since all the surrounding peaks were hidden in cloud, but we were able to find a sheltered spot for lunch with views down into the valley. Thanks to the late spring, the usual display of wildflowers up top was missing. A cold wind picked up along with what we think were a few snowflakes, driving us to hightail it off the rock and to get back into the shelter of the trees. Members: David Adkins, Mari Baldwin, Melody Clarkson, Chris Stockdale, Elle Weaver, Sue Wolling.

Mt. Pisgah Sunrise-Moonset

May 17, 2011

Leader: Royal Murdock

Hike: 3 miles, 1000 ft. (Easy)

AT 5:00 AM, THE FULL MOON WAS SO BRIGHT that I could see my shadow. Then at the trailhead at 5:45, it had disappeared behind the clouds and a few drops of rain were falling. Still we continued to the summit, observing the spectacular spring flowers but not the rising sun or the full moon setting. As usual, as early as we were climbing up we met several people coming down. Members: Janet Jacobsen, Royal Murdock.

Pre's Trail

May 18, 2011

Leader: Margaret Prentice

Hike: 4 miles, 0 ft. (Easy)

AFTER SO MANY RAINY DAYS WE REALLY LUCKED OUT: clouds, warm sunshine and not a drop of rain, perfect weather. Pre's Trail is easy walking, soft underfoot but we did digress for a short time and walked along the bike path to be closer to the river. Along the route we looked at some of the Talking Stones, set there in 2002 to remind us of the culture of the Kalapuya people who hunted there and canoed on the river. The stones reintroduce Kalapuya words, with their English translation. The vegetation was lush, larkspurs and Solomon's seal filled the understory in places. Birds were happy and among those

we identified were western tanager and tri-colored blackbird. Making their way along the canal in a straight line was a family of Canada geese, the goslings quite big already. A few fishermen were trying their luck in the pond. This was a great way to spend a morning with a neat group of fellow outdoor-lovers. Among the seven of us were two nonmembers and by the time you read this Laurie will be a member. Members: Keiko Bryan, Janet Jacobsen, Joanne Ledet, Margaret Prentice, Barb Revere. Nonmembers: Patrick Bronson, Laurie Marshall.

Heceta Head

May 21, 2011

Leader: Pat Soussan

Hike: 7 miles, 400 ft. (Moderate)

A DELIGHTFUL DAY HIKING TO THE HECETA HEAD LIGHTHOUSE from Washburne State Park was enjoyed by a group of seven. Four of the participants had done the hike before, one of whom remembered when the Hobbit Trail had to be crawled through. The weather was pleasant enough - no sunshine but no rain! We started our hike by walking along the sand to the Hobbit Trail. Sights along the beach included a whale carcass with nine or more turkey vultures hovering nearby, and an altar-like alcove carved into the sandstone cliffs. Also, sadly, graffiti was present in the cliffs. No hobbits were spotted on the Hobbit Trail but the wildflowers were quite plentiful on the trails. We identified Oregon iris, Pacific rhododendrons, elderberry, salmonberry, and fringe cup. Two mystery plants were later identified with the help of guide books as western lily of the valley and Hooker's fairy bells. Four members of the group took the Heceta Head lighthouse tour after lunch and found it very informative. Two of our group stayed and talked to the tour volunteers and, instead of returning the way we came, took a shorter route via the lighthouse keeper's house down to Devils Elbow beach. They waited there until the rest of the group completed the hike along the China Creek trail and picked them up. Members: Daniele Delaby, Yuan Hopkins, Barbara Norregaard, Pat Soussan, Kathleen Willett. Nonmembers: Harriet Kelly, Bob Graff.



On Castle Rock, May 15.



Backpacks

Hemlock Butte A-Frame, Mt. Bailey

April 29, 2011

Leader: Scott Hovis

Bk Pk: 13 miles, 1000 ft. (Difficult)

WE WERE SURPRISED HOW MUCH SNOW WAS THERE, at least 8-10 feet, which made it hard to find the shelter. There was so much snow that some of the blue diamonds were buried. Several of them were just several inches above the snow so we spent a good 45 minutes looking around for the A-frame. Snowmobiles were on our trails; we didn't know whether to be grateful or to curse them. They aren't supposed to be on the blue diamond trails, but they at least broke trail. It does detract from the wilderness experience since we could smell the fumes, and they were loud. The wood supply for the wood stove was almost gone, as it often is this time of year. The wood stove makes it easy to reheat burritos and other food and that's how we melted snow for our water. They have a metal trash can for food storage since there are so many rodents in this particular shelter. I thought the snowmobilers were crazy because there is a giant bowl on Mt. Bailey that is definitely avalanche prone and the snowmobilers were joy riding all over the avalanche area. Vistas were great from the ridge where we did our day hike. We could see Mt. Thielsen, Mt. McLoughlin, and Mt. Scott, but we were unable to see Mt. Shasta this time due to haze in the background. Diamond Lake lodge offers a great traditional breakfast which we enjoyed on the way back after our three days and two nights in the outback. According to the fishermen there, the fishing is making a great comeback. There must have been 50 people ice fishing that day on the lake. Members: Scott Hovis, Daphne James.



Paddle Trips

Coyote Creek

May 4, 2011

Leader: Lana Lindstrom

Water: 4 miles, (Easy)

IN THE MORNING, THE REFLECTIONS RESEMBLED a Monet painting -- rich in color and peaceful. But on the return, we saw scintillating diamonds dancing across the water! Lots of bird sounds: yellow warblers, Canada geese, ducks, several osprey, including one eating breakfast, a great blue heron, and five white pelicans were among the sightings. Some of the boats were long, sleek kayaks; others were shorter and squatter; and there was one lone tandem canoe. The weather and the company couldn't have been better. Thanks to the folks for sharing a spec-

tacular morning. Members: Roberta Chord, Clara Emlen, Patricia Esch, Lana Lindstrom, Patricia MacAfee, Sam Miller, Nola Nelson, Jim Whitfield. Nonmembers: Angela Hirst.



Bicycle Trips

Bellfountain

April 23, 2011

Leader: Lyn Gilman-Garrick

Bike: 38 miles, 500 ft. (Moderate)

FINALLY, A GORGEOUS DAY FOR A BIKE RIDE... bright sunshine, no winds to speak of, quiet back roads, good friends! We even found a new route around the steep hill on Coon Road outside of Monroe. The things that stood out on the ride were three fire trucks responding to a fire at a Christmas tree farm, lunch at Bellfountain Park among the fawn lilies and shooting stars, and 35 species of birds identified by George Jobanek who has an amazing ear for birds. Members: Bill Aspegren, Barbara Bruns, Paul Garrick, Lyn Gilman-Garrick, George Jobanek, Royal Murdock, Art Sather, Guy Strahon, Judy Terry.

West Eugene Wetlands Bike & Birding

April 26, 2011

Leader: Anne Montgomery

Bike: 14 miles, 0 ft. (Easy)

I STARTED BIKING TOWARD THE MEETING LOCATION in a slow drizzle while wondering if it would continue to rain during the entire morning. As I crested the Chambers Connector, I glanced right to see sun on the distant western hills! When my two companions and I cycled from the parking lot at 8:30, the rain stopped. Except for a cold wind, we had good weather for our journey. We viewed red-winged blackbirds, mallards, green-winged teals, cinnamon teals, shovelers, American widgeons, Canada geese, red-necked phalaropes, great egrets, great blue herons, red-tailed hawks, meadowlarks, green-violet swallows, barn swallows, and song swallows. We saw a large flock that we tentatively identified as dunlin. Thanks to my two participants for making this a very enjoyable morning. Members: Clara Emlen, Patricia Esch, Anne Montgomery.

Bear Creek Road

May 6, 2011

Leader: Patricia Esch

Bike: 15.5 miles, 600 ft. (Moderate)

A FEW SPRINKLES DIDN'T DISCOURAGE six riders from a peaceful, scenic trip on back roads south of Pleasant Hill. Besides the usual bucolic livestock, someone spotted wild turkeys. The lack of traffic encouraged conversations and we even enjoyed the several hills. Members: Barbara Bruns, Patricia Esch, Richard Hughes, Cathy Irwin, Don Kindt, Lana Lindstrom.



Snowshoe Trips

PCT North of Santiam Sno-Park

April 23, 2011

Leader: Dick Hildreth

SShoe: 6 miles, 1000 ft. (Moderate)

THE WEATHER AND SNOW CONDITIONS WERE OUTSTANDING for the four members and three nonmembers who snowshoed for two hours from the Santiam Sno-Park (across from Hoodoo Ski Area) north on the Pacific Crest Trail to a lunch viewpoint overlooking central Oregon to the east and Three Fingered Jack to the north. The downhill return took an hour and a half via Jack Meadows to the Rockpile at the junction of the PCT and the Skyline Trail. The final backcountry segment to the sno-park involves going south and then southwest down a draw to a small pond, then south above a creek to the snow play area and parking lot. Special thanks to drivers Bill Carpenter and Laurie Funkhouser. Members: Paul Flashenberg, Laurie Funkhouser, Dick Hildreth, Daphne James. Nonmembers: Jessica Bandstra, Bill Carpenter, Elizabeth Burseson.



Trail Maintenance

Spencer Butte

April 23, 2011

Leader: Matthew Bell

Tri Mnt: (Moderate)

THE 1ST ANNUAL RIDGELINE CELEBRATION was a success! The day's events were initiated by Art Farley and the Friends of the Ridgeline.

We took on the task of improving the trailhead. Obsidians of all ages made short work of most of the tasks. We graveled around the trailhead, cleaned the steps, brushed the illicit trails that connect the parking lot with the West Summit Trail, and pruned back the Himalayan blackberries. We accomplished a lot in about 2 hours.

Everyone worked very quickly and finished in time to enjoy the celebrations which included interpretive hikes with city staffers, catered snacks from the Youth Corp, and even a band.

Members: Brennen Babb-Hackett, Maddison Babb-Hackett, Sheila Barry, Matthew Bell, Clara Emlen, Jane Hackett, Janet Jacobsen, Jim Pierce, Jim Whitfield. Nonmembers: Tom O'Brien, Alex Lockfeld, Matthew Lockfeld, Gaybrielle Newell, Douglas Becker, Art Farley, Jo Von Hippel, Conner Bendt, Michelle Emmons, Pat Griffin.



Byways By Bus

Oregon Gardens, Moonstone, Silver Falls

May 17, 2011

Leader: Ethel Allen Asst Leader: Barbara Beard

THE MORNING OF MAY 17, 2011, twenty riders left Eugene by way of McKenzie View Drive. We continued to Marcola and then had a refreshment break at Shot Gun Creek picnic area. From there, we had a scenic drive to Sweet Home, stopping at the city park to view the Weddle covered bridge. Next, a drive through extensive farm land to Stayton, Sublimity and on to Silver Creek picnic area, where we enjoyed a picnic lunch. After lunch, many in our group walked the trail under the south falls. We then continued to Silverton where we stopped by the Norman Rockwell murals. The Four Freedoms was especially interesting. Then on to Moonstone Resort where we checked in early so those who wanted could walk into the Oregon Garden. In the evening, an elegant dinner was served to us in our private dining room.

Wednesday morning a free buffet breakfast was offered in the Garden View dining room. Then a short drive to the Oregon Garden. Next we went to the Gordon House, which was designed by Frank Lloyd Wright. We saw a film showing how the house was moved to the present site. A guide then took us throughout the entire house.

Then on to Mt. Angel where the bus parked near the Glockenspiel restaurant. Mary Grant was our guide for the town. She first turned on the Glockenspiel to go around which depicts the early settlers of the area. We then walked to St. Mary's Church. She took us inside to view the stained glass windows which are beautiful beyond words. The pipe organ is massive. Then back to the restaurant where we enjoyed a fine lunch. Mary then rode with us to the abbey where she was our guide. The Abbey has an extensive campus. We first entered the church to view the beautiful pipe organ. Then on to the library which was donated by Tektronix. We were taken into the vault where old books are kept in a 60 degree climate. We were shown two ancient books. One was from 1250, and the other from 1480. They were perfectly hand printed by using hair from pigs. Pages of the books were made of pig skin. This was a rare experience. Our final stop was the Bauman farm. The farm features hundreds of flowering plants. The store has an abundance of interesting items to purchase, including ice cream of which we did partake.

Our excellent driver was Kevin Nunley. He drove the narrow country roads to perfection. We returned to Eugene about 5:30. Members: Ethel Allen, Ron Bauer, Barbara Beard, Paul Beard, Paula Beard, Sharon Cutsforth, Pat Dark, Barbara Flanders, Dennis Flanders, Marjorie Jackson, Barbara Payne, Don Payne, Virginia Prouty, Liz Reanier. Nonmembers: Judith Philips, Valerie Livering, Frances Paresa, Dennis Sears, Jan Sears, Lexie Simpson.

Extended Trip Report:

Malheur National Wildlife Refuge

May 13-15, 2011

Leader: Marianne Camp Photo: Keiko Bryan

THIS YEARS EXTENDED TRIP TO MALHEUR NATIONAL REFUGE brought many surprises. A group of 13 left town Friday morning under sunny skies with weekend predictions for thunderstorms in Eastern Oregon. It's a good thing Obsidians means onward regardless of the weather forecast. We experienced a lovely travel day with great views of the snow capped mountains, lunch with the Mountain Bluebirds and a stop at Headquarters.

Once we arrived at the Frenchglen Hotel we heard of an owl family living in a tree in back of the hotel. We were able to watch two adults and 3 juvenile great horned owls resting in the tree. You can just imagine how much we all enjoyed having them so close by to observe. One early morning member of our group would watch as the adults returned to the tree from a night of hunting.

We each settled into our rooms, enjoyed a good meal then met outside for an evening walk. The weather was warm and pleasant. Our walk included a view of Steens Mountain with a dark stormy sky and lightning, both horizontal and vertical, with a rumble of thunder. We were able to complete our walk without getting wet.

Saturday morning we met for an early morning drive up to the Page Springs Campground. Rick Ahrens, our resident naturalist, led us on a guided walk up the trail along the Donner Und Blitzen River. Rick helped us identify the different sounds and special markings of the various birds and answered our many questions. We so appreciate his knowledge and wonderful personality. What a pleasure it was to have him on our trip.

We returned for breakfast, loaded up our cars and drove up the Central Patrol Road. It has been a wet spring so the fields and ponds were full of water. We lunched at Benson Ponds with a viewing of two adult great horned owls, one was resting in the nest with the babies. We no sooner finished our lunch and returned to our cars then the rain began. It did stop

long enough for us to do a view from the top of the Buena Vista Overlook before returning to the hotel.

Sunday morning the State Trooper stopped in for breakfast at the hotel to tell us that he had evacuated Page Spring Campground during the night and closed the Central Patrol Road at Peter French's Barn due to flooding. We felt so lucky to have completed all our adventures the day before. What a difference 24 hours can bring.

One group of travelers shared their experience with these

highlights: Wild and dramatic weather, the abundance of water and birdlife, the stunning scenery, observing two adult sandhill cranes walking with their young in the early morning light, a grebe dancing across the water seen through a scope, a Lewis woodpecker and a northern harrier. The three young owls, steps from our hotel, captured our attention and hearts, as well as, seven young, adorable coyote pups seen a mile from the headquarters on Sunday morning. The red-



tail hawk nest, located at the headquarters, with parent and downy offspring was also a treat to watch, as was a porcupine resting in a tree. The variety of birdlife seen in such a short amount of time was awe-inspiring, framed by gorgeous clouds carrying water, snow, hail, thunder, lightning; it was all drama. A veteran birder to this area summed it up with, "I would do this trip again!" - her eyes lit up with excitement and anticipation for the next extended trip to Frenchglen.

That pretty much sums up what we experienced and the joys that each person felt. We collectively saw approximately 90 species of birds. Many sightings of animals, antelope, deer, jack rabbit, cotton tails, coyote, porcupine, and the ground squirrels. Many thanks to all for making this such an enjoyable adventure.

Members: Rick Ahrens, Keiko Bryan, Marianne Camp, Jacque Davis, Patricia Mac Afee, Mary Morrison, Nola Nelson, Margaret Prentice, Bonnie Richman. Nonmembers: Kathy Giesen, Gloria Smith, Kathy Kast, Nancy Raymond.

Spring Basin Wilderness

May 19-22, 2011

Leader & Photo: Chris Stockdale

THERE'S NOTHING LIKE ARRIVING AT THE TRAILHEAD of a hike you've never done to find the parking lot full of emergency vehicles and a helicopter buzzing overhead. This is what awaited us at the start of the Scout Camp trail in the Crooked River Ranch area. Our group was heading for the Spring Basin wilderness trip in the John Day Clarno area and broke the journey to hike this new trail. Apparently a woman had fallen and broken her leg not long before we arrived, and was evacuated by helicopter. It certainly makes you think about treading carefully, especially on this trail which turned out to have some steep, rocky descents and a bit of scrambling. But our group survived to tell about it, and found it to be a spectacular 3-mile loop in the beautiful Deschutes River canyon.

Fourteen of the group arrived for Thursday night at the Hancock Field Station, sharing the OMSI science camp with about 90 kids. With cabins to ourselves and a separate dining area, we could enjoy watching and listening to the exuberance of these kids on their last night in camp without having to join in.

On Friday, we hiked up into the Spring Basin wilderness via a fairly steep and rough trail. Once on the top of the ridge, though, the going was much easier as we followed old ranching roads. The weather was spectacular and we were able to spend plenty of time on top of a couple of high points, relish-

ing the incredible views and looking for numerous different blooming wildflowers. These included hedgehog cactus, bitterroot, balsamroot and phlox, plus several flowers that nobody could identify. A couple of deer were seen running in the distance, and several snakes were almost stepped on. Having determined the first one we saw was not a rattlesnake, we didn't worry too much. (I think it was a western terrestrial garter snake.) Lunch was atop a rocky outcropping with steep drops down to the John Day River valley.

Back at camp we found the six people who had been unable to come on Thursday and spread ourselves around the camp since the kids had gone. While some relaxed with books or snoozed, others hiked some of the 10 miles of trails surrounding the camp, which is located right in the John Day National Monument.

On Saturday we organized a car shuttle, leaving one vehicle at the Spring Basin trailhead. Then we all drove to the Palisades area of the Monument and headed up into the hills again, this time via the Pine Creek Conservation area. A few people turned around part way up, but the rest of us continued on, heading cross-country to scramble up the trailless Horse Mountain. From this great viewpoint, we could plan a route down the other side of the mountain, into the actual Spring Basin valley and then up to the ridge we had visited on Friday in order to descend to the car waiting for us. Not everyone

(Continued on page 15)





UPCOMING BYWAYS BY BUS

The Oregon Zoo

Tuesday, June 21, 2011

Leaders: Rick Ahrens and Liz Reanier

Cost: \$40 members, \$42 nonmembers

Reservations & checks: Mary Lee Cheadle, 689-1085

IN THE REGISTER GUARD ON SUNDAY, May 15, was an article written by Randi Bjornstad about Zuri, a black rhino on loan from the Cleveland Zoo, to breed (hopefully) with Pete, the male black rhino in the Oregon Zoo in Portland. Black rhinos are among the most endangered animals on the planet. In an article in the June/July edition of *National Wildlife Magazine*, it stated that the numbers in its diminished African range are down to about 4,000 today.



Zuri

Zuri was born at the Cleveland Zoo, and weighed 60 pounds at birth. She is now almost four years old and weighs 2,600 pounds. Zuri arrived by FedEx in April. Three years ago, the Oregon Zoo tried to truck a black female rhino to Portland from the Kansas City Zoo. A series of mishaps occurred, the last one being that the animal collapsed in its crate. Despite heroic efforts by the veterinarians from the nearby Phoenix Zoo to save her, Kipenzi died.

Breeding pairs come together only for mating and otherwise do not spend time together, so visitors should not expect

to see a lot of frolicking from Zuri and Pete. If they do breed, gestation period is 15 to 16 months, and mothers and calves stay together for two to three years.

Pete has been at the zoo since the late 1980s, and he and his mate, Miada produced a daughter, Imara, in 1997. Imara now lives in the Great Plains Zoo in South Dakota, where she has given birth successfully. Miada died in 2005 from kidney failure.

Do sign up for the bus trip, so you can see Pete, Zuri, and many more animals!

Fort Vancouver/Hudson's Bay Co.

Tuesday, July 12, 2011

Leader: Mary Ellen West

Cost: \$38 members, \$40 nonmembers

Reservations & checks: Janet Speelman, 344-3019

MARY ELLEN HAS GONE THE EXTRA MILE researching and planning a very busy day at Hudson's Bay Company and British fur trading fort. Walk the garden, climb the bastion and watch blacksmiths, bakers and other costumed interpreters. Visit Officer's Row to view the exterior of 22 restored Victorian era homes plus the inside of the George C. Marshall house. As time permits, Mary Ellen plans to stop at Vancouver barracks and the two replica houses representing the village where 500 workers lived. Plan to bring a picnic lunch—we have the perfect setting. The good news is that you can take nap on the way home after an out of ordinary day.



Spring Basin Wilderness

(Continued from page 14)

wanted to do this one-way trip, so they headed back down to the Palisades. Eight of us accomplished the route-finding hike with no problem and in fact, were back at the car earlier than expected.

Sunday dawned chilly with a threat of rain, and most people packed up to get an early start for the journey home. The trip was deemed a great success, with praise heaped upon the

Hancock station staff, especially our cook, Nancy. They bent over backwards to make sure that we were comfortable, well fed and wanted for nothing.

Members: Lynda Christiansen, Marlene Drescher, Clara Emlen, Paul Flashenberg, Bob Foster, Jane Hackett, Janet Jacobsen, Ed Lichtenstein, Lynn Meacham, Valerie Metcalfe, Nola Nelson, Jim Pierce, Chris Stockdale, Charlie Van Deusen, Jim Whitfield, Nancy Whitfield. Nonmembers: Sharon Friedland, Carol Stern, Kelly Fitzpatrick, Stephen Ramey.

Upcoming Extended Trip:

Rogue River Kayaking

Friday - Sunday, August 12 -14

Leader: Valerie Metcalfe

DO YOU LOVE THE WATER? Are you looking for people to float with? Spend a hot August weekend kayaking the Rogue, in southern Oregon, with a small group of Obsidians. We'll be in the Hellgate Recreation Area of the Rogue River near Galice. The river is beautiful and the rapids are fun, but nothing above class II. We'll pull out before the beginning of the Wild Rogue so no permit is necessary. If you are not familiar with this stretch of water, you are welcome to follow the leader, but be aware that this is not a guided river trip. Life jackets must be worn at all times while on the river.

We'll camp both nights at Almeda campground group site and float the same stretch of river both days. Almeda Campground (Josephine County Parks) is located on the Rogue River, 18 miles west of Merlin. Facilities include pit toilet, drinking water, firewood, ice, and an on-site camp host. Participants can shower at Indian Mary CG at no additional charge.

After setting up camp Friday, participants can do a 5-mile float from Ennis Riffle to Almeda, hike down to Rainie Falls, or hang out by camp. There may even be a live band Friday night at Galice Store and Restaurant, located 3.5 miles back up the road. Saturday we can do a 10-mile float from Hog's Creek down to Almeda CG. For those who still want more time on the water before heading home Sunday, there will be time for an optional 5 mile float after we pack up camp.

Campers will be responsible for their own breakfasts and lunches. Galice store doesn't offer much so plan to bring your food with you. Two dinners are included in the cost of the trip and will be prepared and shared by the group.

This trip is limited to 10 participants. All participants must be over age 21 and must be experienced kayakers. The cost of the trip is \$33 for members, \$38 for nonmembers. If you do not have your own boat, inflatable kayaks can be rented from the University of Oregon Outdoor Program or can be

rented down in Merlin. A pre-trip meeting will be held in early August.

To secure a place on this trip, sign up online, then send your full payment (payable to *Obsidians*) within 5 days to Valerie Metcalfe, 62 E. 23rd St., Eugene, OR 97405. Please include your phone number and email address.

Questions: Contact Valerie Metcalfe at 521-7539 or metcalfev@gmail.com.



An Invitation:

McKenzie River Trail/ Clear Lake Loop Hike June 25 (Sat)

JOIN THE GROUP FROM THE TRAILS CLUB of Oregon Weekend on the McKenzie River for this gorgeous 9.2-mile hike with approximately 400 feet elevation gain. We'll hike on both sides of the McKenzie River, passing 100 ft. and 70 ft. Sahalie and Kosah waterfalls; then hike a 5-mile loop around Clear Lake, resting at Great Springs, the headwaters of the McKenzie River. Bring lunch, lots of water, sunscreen and a hat, as half of the hike around Clear Lake is in direct sun.

Upcoming Extended Trip:

Diamond Lake & Crater Lake

Friday - Sunday, August 26-28

Leader: Rob Castleberry

ROB CASTLEBERRY IS LEADING a three-day/two-night car camping trip to Diamond Lake and Crater Lake, Friday through Sunday, August 26-28.

Camping: Rob has reserved three large campsites for 12 people to put up their tents at Broken Arrow Campground near Diamond Lake. There may also be room for some small RVs. If you have a large RV, need a single campsite, or want to stay at Diamond Lake Lodge, you will need to make your own reservations. The campground has showers. Carpooling is recommended since parking is limited at campsites.

Hiking: Rob and others will be leading moderate or difficult hikes to Tipsoo Peak, Cinnamon Butte Fire Lookout, Mt. Bailey, Scott Mountain, and Garfield Peak. He hopes to lead Watchman Tower after dinner on Friday night.

Food: Friday night will be a potluck. Saturday night, folks can eat at South Shore Pizza. People will need to bring their own breakfasts and lunches. There will be hot water. If you want to drive a few miles, the restaurant at Diamond Lake Lodge is an option.

Cost: Trip fee will be \$2.00 for members and \$5.00 for nonmembers. After you sign up online, you will need to send a \$15 check made out to Rob Castleberry for the reserved campsite and extras. That money is nonrefundable. His address is PO Box 50596, Eugene, Oregon, 97405. If you have any questions, email Rob at robcast@efn.org or call 513-8504.



Diamond Lake and Mt. Thielsen through a hole in Mt Bailey.

Are You Kidding Me?

SO, WHAT DO WE DO WHEN we have space to spare in the *Bulletin* ... well this time a call for jokes went out and Ken Frazer answered. A couple of his submittals:

Why did the cowboy get a dachshund? Someone told him to get a loooong little doggie.

One hydrogen atom ran up to another screaming that someone just stole his electron. The sympathetic hydrogen atom asked, "Are you sure?" The response was, "Yes. I'm positive!"

Not to your liking—send us your best shot.

Date Change:

Hiking Mt Hood Extended Trip

A CONFLICT HAS REQUIRED THE LEADER to change the dates of this trip from Sept 15-17, moving to one week earlier: Wed-Fri. September 7-9. The trip itinerary remains unchanged. Please consult the May Bulletin for a full trip description, or call leader Joe Sanders at 255-2524. As of this writing (5/28) there are still up to eight openings for this trip.

Note: A nice added perk is that Vicki Wood, a personal friend of Joe's and Trails Club board member, will be our lodge hostess for the two nights on the new dates we will spend at Tyee lodge, and will be hiking with us, adding her local knowledge and fitness to our experience as guests and hikers.

Joe Sanders, Extended Trip Leader



POTLUCK

Friday, June 24:

Grand Canyon - Rim-to-Rim

MARGARET AND RICHARD ESSENBERG WILL SHOW photos of their September 2010 Grand Canyon 13-day trip and rim-to-rim hike. Learn about geology, history, hiking, reservation tips, and how to really enjoy and soak up the spectacular views and colors. Grand Canyon National Park is one of the world's premier natural attractions, attracting about five million visitors per year. The average visit to the Park is about three hours or less, some sources say 15 minutes. Come find out how much the Canyon has to offer.

COME EARLY, AT 5:30 PM for the courtyard pre-dinner social with sparkling apple cider. There will be special badges for anyone who has visited or hiked the Grand Canyon. This is an opportunity for members and guests to help kick off the summer hiking season.

Susan Wanser, Entertainment Chair

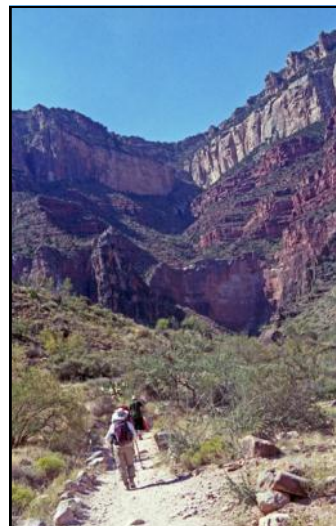

June Potluck • Friday, June 24 • Social 5:30/Potluck 6:30/Program 7:30 • Obsidian Lodge

Bring your favorite potluck dish to share, along with plates, utensils and cups, plus \$1 to help cover club expenses.



ExploraTalk Thursday, June 16, 7:00 pm at the Lodge:

Oregon's Outback, a Fragile Beauty



DEVON COMSTOCK, HART-SHELDON CONSERVATION COORDINATOR with Oregon Natural Deserts Association (ONDA), will present a program on the natural and human history of the Hart Mountain and Sheldon National Wildlife Refuges. She will also talk about ONDA's ongoing work with the US Fish and Wildlife Service to study and enhance the ecological connection between the two refuges, as well as opportunities for community members to assist in this project and other habitat restoration efforts.

The Greater Hart-Sheldon Ecosystem spans over 3 million acres in remote southeastern Oregon and northern Nevada, encompassing both the Hart Mountain National Antelope Refuge and Sheldon National Wildlife Refuge. Both these high desert refuges were created for the conservation of the pronghorn antelope. Management has since grown

to include conservation of a wide variety of wildlife and the restoration of native ecosystems found within the refuges.

Lyn Gillman-Garrick, Conservation/SciEd Committee

Obsidians in the Media

BILL SULLIVAN MENTIONED THE OBSIDIANS in his hiking article, *A Hidden Beauty: Nesika Lodge atop Multnomah Falls*, in *The Register Guard*, 5/24/2011.

Sullivan wrote that the Trails Club of Oregon, formed in 1915, built Nesika Lodge in 1923. When it was rebuilt in the 1980s, they asked NW hiking clubs to donate a rock for the chimney hearth, "Appropriately, the Obsidians club of Eugene sent a huge chunk of obsidian. It's still part of the chimney, identified with a plaque."

This was not the first time that Obsidians made a contribution to a lodge. The *Bulletin* of July 1960 notes that Obsidians attended the dedication of the Mazama Lodge:

Nineteen outdoor clubs donated plaques. Only the Angora Club of Astoria had a plaque the same size as the Obsidians. Most of them were 8" by 8" or just the shape of the club's emblem. One small plaque came from Japan, inscription said "Organized in 1905". Another square was from Italy. The Chemeketans' was unique - their 'thunderbird' on the state of Oregon as a background. The day ended with a drive to Timberline Lodge to see the three million candle power lights at the top of Mt. Hood. A fine breakfast was had at 8 am, but while eating, the first of 235 Mazama climbers reached the summit, heard on the walkie-talkie. (Obsidians climbers led by Lloyd Plaisted participated in this event.)

Editor's note: The oldest outdoor club in Oregon is the Mazamas founded in 1893. The Obsidians club was founded in 1927.

Classifieds

Hiking Companion Sought

I am planning a week of hiking in the Sierra Nevada National Park of southern Spain from October 8 – 15, 2011 and then in the Sierra de Grazalema National Park from October 15 – 22, 2011. For the first week I have reserved a casita in Bubion at the southern edge of the park and for the second week I have reserved a casita in Benahoma. I am planning on day hikes most days in the Sierra Nevada as well in Grazalema, along with cultural explorations – especially in the 'white hill villages' in Grazalema.

If you are interested in this kind of trip please contact me: Rand Schenck at 503-347-5526 or email me at rand-schenck@msn.com.

For Sale

WOOD - GREEN FIR at the Obsidian Lodge. Split, you haul. \$110/cord, or we can haul for \$40. Half cords available too. Contact John Jacobsen, Grounds Chair:

343-8030 or johnwjacobsen@comcast.net

Note: There is no charge for placing Obsidian Bulletin Classified ads; however, only members can place ads and preference will be given to ads that relate to the club's mission and our members' outdoor activity interests.

Obsidian Calendar

June

11 Sat - Dog Mountain, Hike D , Lipton	736-7498
15 Wed - Crevasse Rescue class session , ClbSch , Still	344-7324
16 Thu - Hart Mtn & Sheldon Nat Wildlife	ExploraTalk
16 Thu - North Shasta Loop , Hike M, Romoser	726-8154
17 Fri - Marys Peak , Hike M, Christensen	343-8941
17 Fri - Get Acquainted Hike , Hike E, Jacobsen	343-8030
18 Sat - Tire Mountain , Hike M, Pierce	344-1775
18 Sat - Crevasse Rescue , ClbSch , Still	344-7324
18 Sat - Chi Gong & Meditation , Hike M, Lipton	736-7498
18 Sat - Get Acquainted Hike , Hike E, Jacobsen	343-8030
19 Sun - Lorane to Drain , Bike D, Hegg	484-0619
19 Sun - Silver Falls , Hike M, Hovis	521-3663
21 Tue - Mt. Pisgah Summer Solst , Hike E, Jacobsen .	343-8030
21 Tue - Oregon Zoo , Bus , Reanier	687-1925
24 Fri - Grand Canyon Rim-to-Rim - Essenbergs	Potluck
25 Sat - Three Pyramids , Hike M, Hamilton	343-6550
25 Sat - Olallie Mountain , Hike M, Graham	933-1612
25 Sat - Coast Range , Bike M, Gilman-Garrick	345-5236
25 Sat - McKenzie Rv/Clear Lk , Hike M, Sanders	255-2524
26 Sun - Rebel Rock , Hike D, Huff	868-5391
26 Sun - Iron Mountain , Hike M, Lipton	736-7498
28 Tue - Ribbon Trail , Hike E, Welches	345-2056
29 Wed - Spencer Butte , Trl Mnt , Bell	503-884-8829
30 Thu - Bunchgrass Ridge , Hike D, Stockdale	767-3668

July

2 Sat - Chi Gong & Meditation , Bk Pk M, Lipton	736-7498
6 Wed - Board Meeting, Lodge 6 pm	
8 Fri - Orchard Point , Bike M, Esch	338-8280
9 Sat - Eula Ridge , Hike D, Harris	521-5807
9 Sat - Cone Peak/Iron Mountain , Hike M, Wolling ...	345-2110
10 Sun - Crescent Mountain , Hike D, Adkins	344-4163
12 Tue - Fort Vancouver , Bus , West	343-5492
15 Fri - Get Acquainted Hike , Hike E, Jacobsen	343-8030
16 Sat - Lowder Mountain , Hike M, Duncan	343-8079
16 Sat - Substitute Point , Hike D, Christiansen	687-8379
17 Sun - Mt. Thielsen , Climb M, Harris	521-5807
17 Sun - Threemile Lake , Hike M, Hovis	521-3663
18 Mon - Mt. St. Helens , Climb , Blumm	343-8830
23 Sat - Mt. Jefferson , Climb , Deeter	954-0924
23 Sat - Lillian Falls/Goddard Tr , Hike E, Strahon	689-0753
24 Sun - Tam McArthur Rim , Hike M, Terry	345-0720
24 Sun - Cottage Gr/Lorane , Bike D, Gilman-Garrick	345-5236
25 Mon - Mt. St. Helens , Climb , Pierce	344-1775
27 Wed - Spencer Butte , Trl Mnt , Bell	503-884-8829
31 Sun - Silver Creek Falls , Hike E, Pierce	344-1775

August

1 Mon - Glacier Travel Experience , ClbSch , Sullivan	342-6546
5 Fri - Ribbon Trail - AM , Hike E, Jacobsen	343-8030
5 Fri - Ribbon Trail - PM , Hike E, Jacobsen	343-8030
6 Sat - 4Ts Trail - Portland , Hike E, Ewing	344-9197
6 Sat - Goodman Creek , Hike M, Hoeg	484-6196
6 Sat - Sawtooth Mountain , Hike D, Hoyland	338-9881
6 Sat - Row River , Bike M, Strahon	689-0753
7 Sun - Lowder Mountain , Hike M, Terry	345-0720
11 Thu - Cape Arago, Shore Acres , Bus , West	343-5492



Coyote pups spotted on the Malheur Extended Trip (see trip report on Page 13). Photo by Keiko Bryan

June 2011

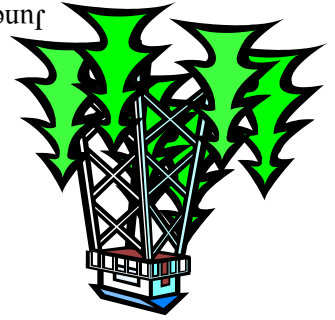

RETURN SERVICE REQUESTED

OBSIDIANS, INC.
P.O. BOX 51424
EUGENE, OR 97405



OBSIDIANS, INC. IS A NON-PROFIT ORGANIZATION

PRESORTED STANDARD
 US POSTAGE
PAID
 EUGENE, OR
 PERMIT 803